

# HFT 1200 Series

## High Flow Tied Diaphragm Threaded Regulator

aerospace  
climate control  
electromechanical  
filtration  
fluid & gas handling  
hydraulics  
pneumatics  
process control  
sealing & shielding

### Customer Value Proposition:

The HFT1200 regulator offers high flow capability with an inlet pressure up to 1,250 psig. The large convoluted Hastelloy C22<sup>®</sup> diaphragm provides stable pressure control over the operational range of the regulator.

The tied diaphragm provides positive seal shut off for hazardous gas applications.

The combined high flow and high inlet pressure increases the application range of the regulator thus reducing regulator inventories.



### Contact Information:

Parker Hannifin Corporation  
Veriflo Division  
250 Canal Blvd  
Richmond, California 94804

phone 510 235 9590  
fax 510 232 7396  
veriflosales@parker.com

[www.parker.com/veriflo](http://www.parker.com/veriflo)

### Product Features:

- High inlet pressure with 1.2 C<sub>v</sub> to meet a variety of applications.
- Hastelloy C-22<sup>®</sup> diaphragm for high corrosion resistance.
- Tied diaphragm for positive shut off.
- 59% larger effective area of the diaphragm than other manufacturers.
- Large convoluted diaphragm provides stable pressure control.
- Seat material selection for media compatibility.



ENGINEERING YOUR SUCCESS.

# HFT1200 SERIES REGULATOR

## FLOW CURVE 30 psig

HFT1200 Regulator with 1/2" Face Seal Connections  
Inlet Pressure: 50 psig, N2  
Outlet Pressure: 30 psig

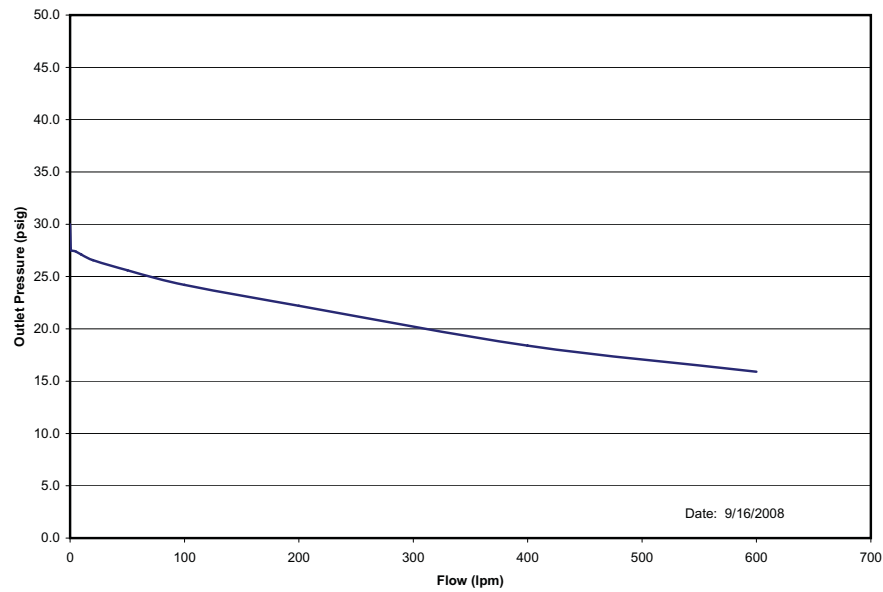

## FLOW CURVE 50 psig

HFT1201 Regulator with 1/2" Face Seal Connections  
Inlet Pressure: 120 psig, N2  
Outlet Pressure: 50 psig

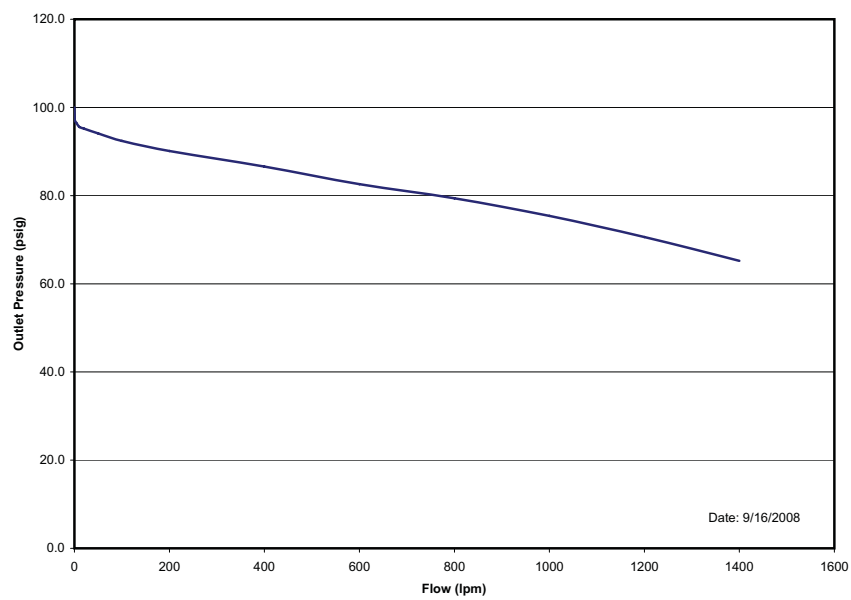

# FLOW CURVE 100 psig

HFT1202 Regulator with 1/2" Face Seal Connections  
 Inlet Pressure: 600 psig, N2  
 Outlet Pressure: 150 psig

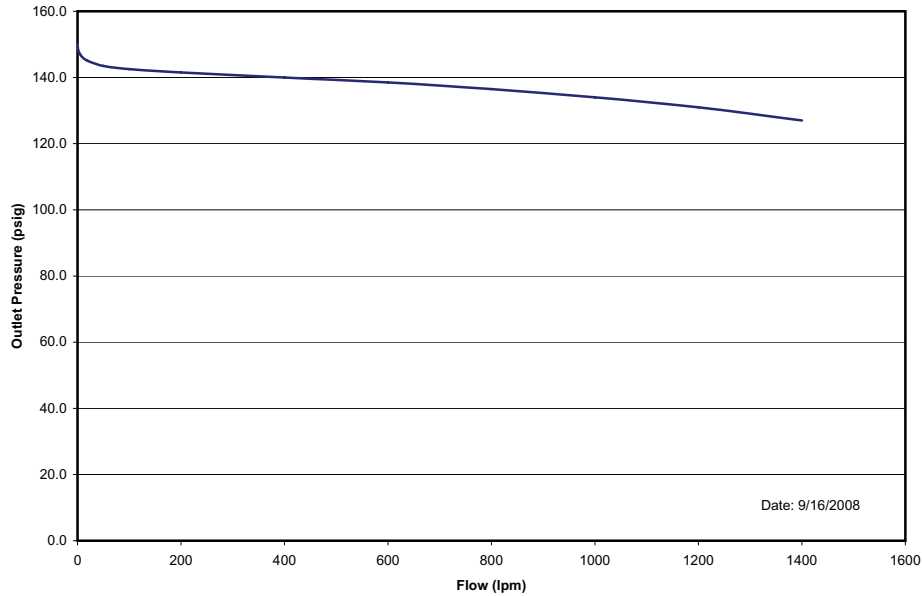

## DIMENSIONAL DRAWING

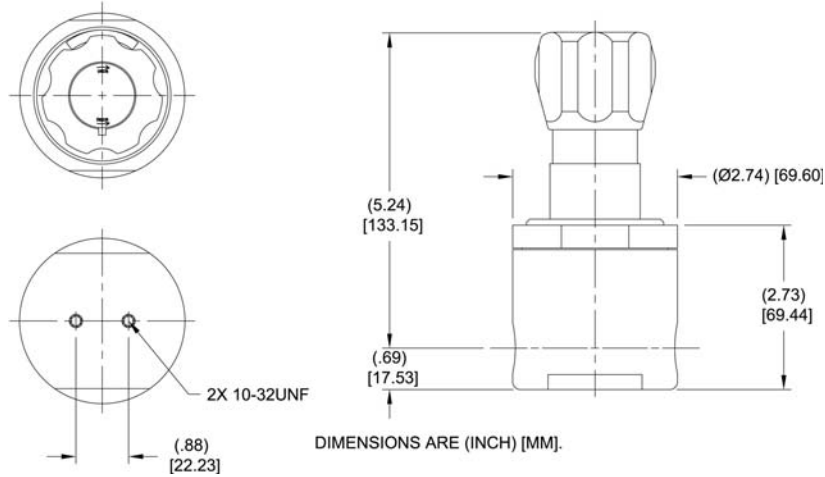

OFFER OF SALE:

The items described in this document are hereby offered for sale by Parker-Hannifin Corporation, its subsidiaries or its authorized distributors. This offer and its acceptance are governed by the provisions stated in the detailed "Offer of Sale" elsewhere in this document or available at [www.parker.com/veriflo](http://www.parker.com/veriflo)

 **WARNING USER RESPONSIBILITY**

FAILURE OR IMPROPER SELECTION OR IMPROPER USE OF THE PRODUCTS DESCRIBED HEREIN OR RELATED ITEMS CAN CAUSE DEATH, PERSONAL INJURY AND PROPERTY DAMAGE.

This document and other information from Parker-Hannifin Corporation, its subsidiaries and authorized distributors provide product or system options for further investigation by users having technical expertise.

The user, through its own analysis and testing, is solely responsible for making the final selection of the system and components and assuring that all performance, endurance, maintenance, safety and warning requirements of the application are met. The user must analyze all aspects of the application, follow applicable industry standards, and follow the information concerning the product in the current product catalog and in any other materials provided from Parker or its subsidiaries or authorized distributors.

To the extent that Parker or its subsidiaries or authorized distributors provide component or system options based upon data or specifications provided by the user, the user is responsible for determining that such data and specifications are suitable and sufficient for all applications and reasonably foreseeable uses of the components or systems.

# HFT 1200 Series Specifications

Materials of Construction		Functional Performance	
<b>Wetted</b>		<b>Design</b>	
Body	316L Stainless Steel	Burst Pressure	3,750 psig (259 barg)
Diaphragm	Hastelloy C-22® Std	Proof Pressure	1,875 psig (129 barg)
Diaphragm Backup	Hastelloy C-22®	<b>Flow Capacity</b>	
Poppet	316L Stainless Steel	Standard	C <sub>v</sub> 1.2
Poppet Spring	316 Stainless Steel	<i>SEMI Flow Coefficient Test #F-32-0998316L Stainless Steel</i>	
Seat	PCTFE, Vespel®	<b>Design Leak Rate</b>	
<b>Non-Wetted</b>		External seal	Bubble Tight
Nut	17-4 Ph	Internal seat	Bubble Tight
Cap	Nickel Plated Brass	<b>Supply Pressure Effect</b>	
Knob (Black)	ABS Plastic		5.9 psig/100psig
<b>Operating Conditions</b>		<b>Standard Configuration</b>	
Maximum Inlet	1,250 psig (86 barg)		1/2" NPT Female
Outlet	5-50 psig (3 barg), 5-100 psig (7 barg), 5-150 psig (10 barg), 20-200 psig (14 barg)		1/2", 3/4" A-LOK Compression Fittings
Temperature:		<b>Approx. Weight</b>	4.2 lbs. (1.9 kg)
PCTFE	-40°F to 150°F (-40°C to 66°C)		
Vespel	-40°F to 150°F (-40°C to 66°C)		

## Ordering Information

